



Tel : +27 47 401 6400
Fax : +27 47 401 6431
Email: info@kinghintsacollege.edu.za

REQUEST FOR QUOTATION

RFQ NO: KHC/RFQ/08/2024

Technical Enquires: Ms Makwezela (Msobomvu Campus Manager)
Contact Details 0615288703

SCM Queries: Ms Cwayi
Contact Details: 047 401 6400

PROJECT DESCRIPTION: BUILT-IN COMPUTER, WORKSHOP DESKS AND CABINETS FOR THE STEM CENTRE

REQUISITION SPECIFICATION

Item	Full Descriptions	Quantity
1.	Computer Desks and 1 cabinet. <ul style="list-style-type: none">• Chip board material, Burgandy Mahogany ash• Edging impact 1mm Burg/Mahogany• Screws drywall 41mm• Screws drywall 28mm• Screws chipboard 8x16mm• Legs Satin 100mmx50mm• Leg Satin 870mmx80mm• Hinge 110 DEG Full overlay straight• Handlebar Decor steel 128mm	2 Desks to sit 30 students. 1 cabinet with 4 shelves and 2 lockable Doors (See diagram below)
2.	Electronics Lab and 1 Cabinet	2 Desks to sit 30 students Cabinet with 4 shelves and 2 lockable doors (See picture below)

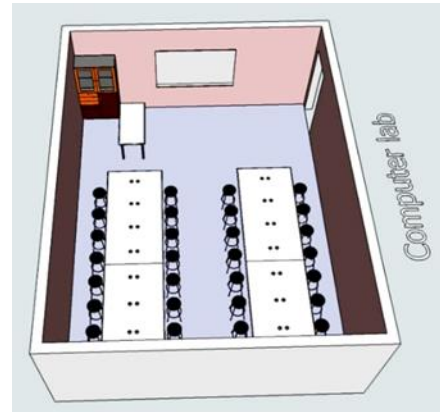

	<ul style="list-style-type: none"> • Chip board, Burgandy Mahogany ash • Edging impact 1mm Burg/Mahogany • Screws drywall 41mm • Screws drywall 28mm • Screws chipboard 8x16mm • Legs Satin 100mmx50mm • Leg Satin 870mmx80mm • Hinge 110 DEG Full overlay straight • Handlebar Decor steel 128mm 	
3.	Supply, Assembling and installation	x2 venues

DRAWINGS

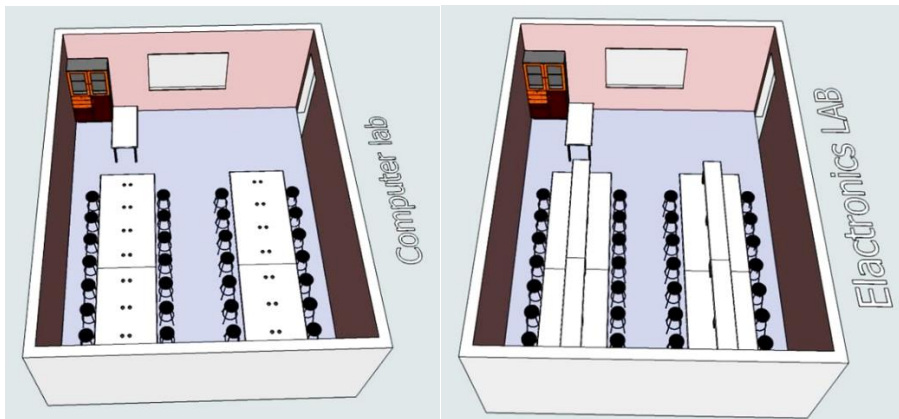

Electronics Lab Desks Dimensions

Quotations and compliance documents must be emailed to the following address: bcwayi@kinghintsacollege.edu.za

Closing Date: 11 March 2024 @ 16h00

PLEASE NOTE THAT NO LATE SUBMISSION WILL BE ACCEPTED